



# NEXLER Adhesive for Bituminous Felt and Shingles

Bituminous roofing adhesive

## TECHNICAL DATA

<b>Ingredients</b>	insulating asphalts, resins, fibres, additives
<b>Drying time of the adhesive depending on the conditions and cross-section of the crevice</b>	10 - 14 days
<b>Density</b>	1,25 - 1,45 g/cm <sup>3</sup>
<b>Flowability at temperature (60 ± 2) °C and inclination of 45° after 5 h - roofing felt bonded with asphalt binder</b>	unacceptable displacement of the roofing felt and leakage of the binder
<b>Pensky-Martens flash point</b>	no less than 40°C
<b>Flexibility when bending on a roller with a diameter of 30 mm at temperature -5 °C</b>	no scratches or cracks
<b>Adhesive strength of the roofing felt to roofing felt</b>	no less than 150 N
<b>Water content</b>	no more than 0,5% (m/m)
<b>Consumption - 5 x 5 mm joint</b>	approx. 12 rm from a cartridge
<b>Application temperature</b>	from +5°C to +35°C
<b>Reference document(s)</b>	PN-B-24620:1998; PN-B-24620:1998/Az1:2004

## PROPERTIES

- Excellent adhesive properties
- Very good adhesion to mineral substrates and bituminous felt
- Resistant to ageing
- Resistant to weather conditions, high and low temperatures
- Resistant to UV radiation
- Resistant to drainage, permanently flexible
- Quick and easy to use
- Ready-to-use



DURABLE INSTALLATION UNDER DIFFICULT CONDITIONS



RESISTANT TO DRAINAGE



HIGH BONDING CAPABILITY

## APPLICATION

- Bonding of bituminous felt shingles
- Bonding of bituminous felt coverings
- Filling of cavities in bituminous felt coverings
- Carrying out roofing repairs (removing blisters, sealing cracks and seams in bituminous felt)



FOR ROOFS



VERTICAL AND HORIZONTAL



CARTRIDGE

## PACKAGING

### Poland

- Cartridge: 300 ml
- Quantity per box: 12 pcs.

### Export

- Cartridge: 300 ml
- Quantity per box: 12 pcs.

## METHOD OF APPLICATION

### ▪ CONDITIONS OF USE

The temperature of the substrate and air during the works should be from +5°C to +35°C.

The product is intended for outdoor use. Works should not be carried out during precipitation and strong sunlight.

### ▪ SUBSTRATE PREPARATION

Before applying **NEXLER Adhesive for Bituminous Felt and Shingles** the surface should be properly prepared. The substrates should be cleaned mechanically, dust, any loose layers and impurities that worsen adhesion should be removed. Clean the existing bituminous felt substrates from loose impurities, peeling coatings and sealing agents. Cut, clean and dry any blisters that appear on the bituminous felt. Prime mineral substrate with NEXLER Penetrator G7.

### ▪ PRODUCT CONTROL

Check the production date on the packaging before use. Do not use the product beyond its shelf life. The product should have a homogeneous consistency.

### ▪ PRODUCT PREPARATION

**NEXLER Adhesive for Bituminous Felt and Shingles** is a ready-to-use product. If stored at low temperatures, the product should be placed in a warm room for a minimum of 24 hours before use.

### ▪ APPLICATION METHOD

The adhesive should be applied with a cartridge squeezer.

When bonding bituminous felt, the adhesive should be applied to the dedicated substrate, then joined and pressed together. When bonding shingles, the adhesive should be applied in patches of approximately 4 cm in diameter, then joined and pressed together. Cut the blisters crosswise, glue underneath and then brush adhesive on top.

### ▪ CONTROL OF PERFORMANCE

When applying the adhesive, care should be taken to ensure that it is evenly applied to the substrate. The bonded element should adhere well to the substrate and there should be no bulges on the surface indicating uneven distribution of the product.

## TOOLS AND TOOL CLEANING

Squeezer.

Clean the tools with petrol solvents. If the product dries, leave it in the solvent until the dirt dissolves.

## STORAGE AND TRANSPORT

The shelf life of the product is 18 months from production date specified on the packaging. Store in rooms with a temperature of +5°C to +25°C in tightly sealed, original packaging. Protect from moisture.

## NOTES

Works should be carried out in accordance with technical conditions, manufacturer's instructions, health and safety standards and regulations. For information on how to deal with symptoms of disease, allergies or irritation of the skin or eyes, please refer to the Safety Data Sheet ([www.nexler.com](http://www.nexler.com)).

After completing the work, the remaining content of the product and container should be handed over to authorized companies.

## GENERAL RECOMMENDATIONS

Technical data and information on the method of use are given for a temperature of 23°C ± 2°C and a relative air humidity of 55%. In other conditions, the setting (drying) time may change significantly.

The consumption of the product given in this sheet depends on the preparation of the substrate.

Do not use for tar materials.

Do not use the product inside rooms intended for the stay of people and the food industry.

## SAFETY INFORMATION

Flammable liquid and vapour. Causes skin irritation. Causes serious eye irritation. May cause damage to organs through prolonged or repeated exposure. If medical advice is needed, have product container or label at hand. Keep out of reach of children. Keep away from heat, hot surfaces, sparks, open flames and other ignition sources. No smoking. Wash hands and exposed parts of the body thoroughly after handling. Wear protective gloves/protective clothing/eye protection/face protection. Dispose of contents/container to according to the instructions of the manufacturer or person authorized to dispose of waste.

## IMPORTANT INFORMATION

Please refer to the detailed conditions of use of the product before use. We guarantee the quality of our materials as part of our terms of sale and delivery.

For buildings with special requirements that are not covered by this manual, we provide our Customers with our own professional advisory service.

The manufacturer has no influence on the improper use of the material, its use for other purposes or under conditions other than those described above. The guarantee only covers the quality of the delivered product. The correct and therefore effective use of the product is not subject to our control.

Neither the manufacturer nor his authorized representative may be held liable for any loss incurred as a result of improper use or storage of the product.

Employees of the company are authorized to provide technical information only and solely in accordance with this technical data sheet. Information other than that contained in this sheet should be confirmed in writing.

If you have any doubts, consult the manufacturer.

Once we have issued a new technical data sheet, this manual is no longer valid.

## CONTACT DETAILS

NEXLER sp. z o.o.  
Łużycka 6, 81-537 Gdynia, Poland  
tel.: +48 58 712 94 44  
www.nexler.com  
e-mail: dt@nexler.com

## DETAILS

### Waterproofing of a sloping roof

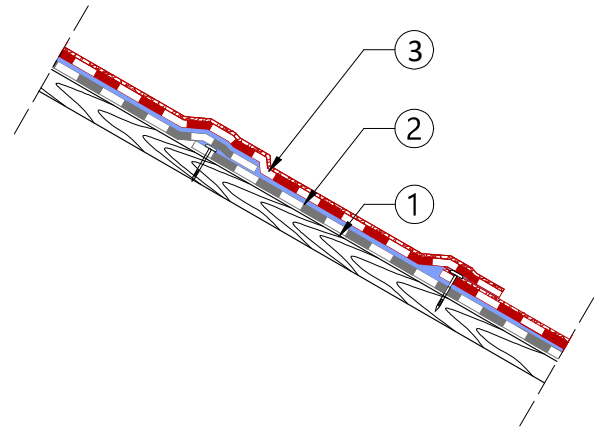

1. Wooden or wooden-like substrate
2. Base bituminous felt mechanically fixed by nails with pads
3. Top coat bituminous felt bonded with **NEXLER Adhesive for Bituminous Felt and Shingles**