



NEXLER Lepik na Zimno

Asphalt glue modified with SBS

TECHNICAL DATA

Ingredients	mixture of asphalts, solvents and performance additives
Flowability at temperature (60 ± 2)°C and inclination of 45° after 5 hours - roofing felt stuck with asphalt binder	unacceptable displace of the roofing felt and leakage of the binder
Flexibility when bending on a Ø 30 mm roller at temperature -5°C	no scratches or cracks
Pensky-Martens flash point	no less than 31- 40°C
Water content	no more than 0,5% (m/m)
Adhesive strength of the roofing felt to roofing felt	no less than 150 N
Drying time	approx. 24 h
Consumption: - bonding of asphalt felt - bonding of mineral wool - damp proofing	0,7 kg/m ² 1,3 kg/M. ² 1,5 - 3 kg/m ² - thickness of a dry layer approx. 1 - 2 mm
Application temperature	from +5°C to +30°C
Reference document(s)	PN-B-24620:1998; PN-B-24620:1998/Az1:2004

PROPERTIES

- Modified with SBS
- Excellent adhesive properties
- Very good adhesion to substrate
- Resistant to weather conditions, high and low temperatures
- Particularly resistant to aging
- Quick and easy to use



RESISTANT TO LOW AND HIGH TEMPERATURES



GOOD ADHESION TO SUBSTRATES



FLEXIBLE

APPLICATION

- Bonding of traditional asphalt felt to mineral substrates and to asphalt felt in multi-layer systems
- Bonding of mineral wool boards for thermal insulation of flat roofs
- Damp proofing insulation of underground parts of buildings and structures



FOR FOUNDATIONS, FOR ROOFS



TROWEL



SPATULA

PACKAGING

Poland

- Packaging: 5 kg, 10 kg, 20 kg
- Quantity per pallet:
 - 5 kg - 80 pcs.
 - 10 kg - 60 pcs.
 - 20 kg - 21 pcs.

METHOD OF USE

▪ CONDITIONS OF USE

The temperature of the substrate and air during the works should be from +5°C to +30°C.

Works should not be carried out during precipitation and strong sunlight.

The product is intended for outdoor use. During the works, very good ventilation of the work area should be ensured.

▪ SUBSTRATE PREPARATION

The concrete substrate intended for the application of the product must be bound, continuous, seasoned, load-bearing and dry. The substrates should be cleaned mechanically, dust, any loose layers and impurities that worsen adhesion should be removed. Any sharp edges should be deburred or chamfered. If there are cavities in the substrate, honeycombing, gravel pockets and other unevenness, the substrate should be levelled and the cavities should be filled. Any external right angles should be bevelled, and internal angles rounded off. The substrate must be free of frost, ice and water stagnation.

Clean the existing bituminous felt substrates from loose impurities and peeling coatings. Any blisters and bulges in the bituminous felt should be cut crosswise and glued with **Lepik na Zimno**. Larger cavities should be filled with filler. Repair any flashings and surface drainage elements. Examine and repair the fixing of other elements on the surface.

The concrete substrate and old, existing insulations made of asphalt felt should be primed with the NEXLER Penetrator G7 priming solution. Do not allow dirt on the priming layer. When bonding new bituminous felt to each other, priming is not required.

▪ PRODUCT CONTROL

Check the production date on the packaging before use. The product should not be incorporated beyond its shelf life. The product should not be objectionable (e.g. contain lumps, fibres, discolouration) after opening. After mixing, the compound should be homogeneous and free of lumps and clumps resulting from under-mixing. The correct consistency of the product is not dry or rubbery. When properly mixed, the product forms a homogeneous coating when spread over the surface with a tool.

▪ PRODUCT PREPARATION

Lepik na Zimno is a ready-to-use product. A solvent may be released on the surface of the stored product. This does not indicate a defect or poor quality of the product. Before use, the product should be mixed until a homogeneous mass is obtained. It is recommended to get the product to room temperature before using at low temperature. Therefore, before using, in that case, it is recommended to put the packaging with the product in a warm room for 1 - 2 days.

▪ APPLICATION METHOD

Bonding asphalt felt to substrates and bonding asphalt felt together: The thoroughly mixed mass is applied to the substrate with a roofing brush, a float or a trowel. It is important that the bonding surface is completely covered with adhesive. Approximately 20 minutes after application, lay the bituminous felt strip and press well to the substrate, in such a way as to squeeze 5 - 10 mm of adhesive onto the bituminous felt lap. Maintain the required overlaps of the bituminous felt. Brush the top of the joints with an adhesive and sprinkle with bituminous felt topping.

Bonding of mineral wool: The thoroughly mixed compound is applied with a trowel to the underside of the wool boards in approx. 8 cm wide strips, on average 4 strips per metre, in the central area of the roof. In the edge and corner areas, the strips are laid closer to each other. After waiting for approximately 20 minutes, the mineral wool should be bonded by being pressed to the substrate. Fixing of mineral wool using the bonding method can be carried out for buildings lower than 12 m. For taller buildings and buildings exposed to particularly high wind loads, mechanical fixing must be used.

Waterproofing of vertical and sloping surfaces (walls): It is recommended to apply the product in two or three layers. Each following layer should be applied after the previous one is bound. Apply material by hand, using a roofing brush, a steel float and a trowel. In all service penetrations, on cement mortar facets and in corners, embed technical fabric (mesh) into the first layer. Carry out further work (protective-thermal insulation layers and backfilling of excavations) after the waterproofing coating has dried. Do not allow rainwater to penetrate the partition and go under the waterproofing layer from the substrate side. Provide a 10 cm overlap at the connection to the horizontal insulation on the footings.

▪ CONTROL OF PERFORMANCE

Thickness of a layer should be checked by material consumption control on a dedicated surface. In addition, it is recommended to measure the thickness of the freshly applied sealing layer with special inspection plates (coating thickness meter), the measurement point should be filled with putty immediately. After it has dried, a properly made coating should be a uniform, clean surface, without flakes and other defects and it should adhere tightly to the substrate.

TOOLS AND TOOL CLEANING

Notched steel trowel, spatula, trowel.

Clean the tools with petrol solvents. If the product dries, leave it in the solvent until the dirt dissolves.

STORAGE AND TRANSPORT

The shelf life of the product is 12 months from production date specified on the packaging. Store in dry and cool rooms, at temperature above +5°C, in tightly sealed, original packaging. Do not allow long exposure to high temperatures or sunlight during storage and transport. The product is not sensitive to negative temperatures.

NOTES

Works should be carried out in accordance with technical conditions, manufacturer's instructions, health and safety standards and regulations.

For information on how to deal with symptoms of disease, allergies or irritation of the skin or eyes, please refer to the Safety Data Sheet (www.nexler.com).

After completing the work, the remaining content of the product and container should be handed over to authorized companies.

GENERAL RECOMMENDATIONS

Technical data and information on the method of use are given for a temperature of 23°C ± 2°C and a relative air humidity of 55%. In other conditions, the setting (drying) time may change significantly.

The consumption of the product given in this sheet depends on the preparation of the substrate.

Do not use the product in combination with polystyrene foam.

Do not use for tar materials.

SAFETY INFORMATION

Flammable liquid and vapour. Keep out of reach of children. Keep away from heat, hot surfaces, sparks, open flames and other ignition sources. No smoking. Wash hands and exposed parts of the body thoroughly after handling. Wear protective gloves/protective clothing/eye protection/face protection. Dispose of contents/container according to the instructions of the manufacturer or person authorized to dispose of waste.

IMPORTANT INFORMATION

Please refer to the detailed conditions of use of the product before use.

We guarantee the quality of our materials as part of our terms of sale and delivery. For buildings with special requirements that are not covered by this manual, we provide our Customers with our own professional advisory service.

The manufacturer has no influence on the improper use of the material, its use for other purposes or under conditions other than those described above. The guarantee only covers the quality of the delivered product. The correct and therefore effective use of the product is not subject to our control.

Neither the manufacturer nor his authorized representative may be held liable for any loss incurred as a result of improper use or storage of the product.

Employees of the company are authorized to provide technical information only and solely in accordance with this Technical Data Sheet. Information other than that contained in this sheet should be confirmed in writing.

If you have any doubts, consult the manufacturer.

CONTACT DETAILS

NEXLER sp. z o.o.

Łużycka 6, 81-537 Gdynia, Poland

tel.: +48 58 712 94 44

www.nexler.com

e-mail: dt@nexler.com

ISSUE DATE

This Technical Data Sheet was issued on 11.03.2025.

Once we have issued a new Technical Data Sheet, this one is no longer valid.

DETAILS

Waterproofing of a sloping roof

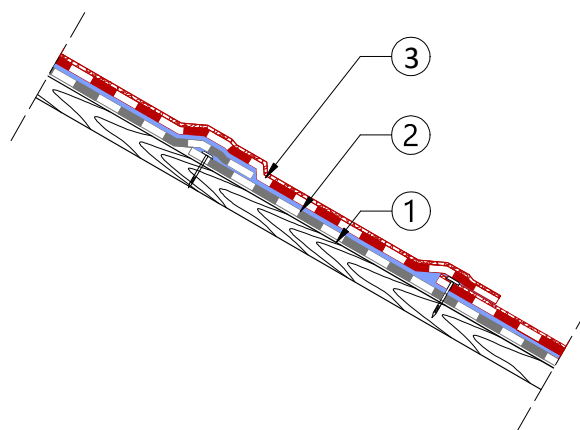

1. Wooden or wooden-like substrate
2. Base bituminous felt mechanically fixed by nails with pads
3. Top coat bituminous felt bonded with **NEXLER Lepik na Zimno**