



IZOHAN RR

Cold applied mineral-asphalt mix for partial repairs of road pavement

TECHNICAL DATA

| Composition | mix of asphalts, natural aggregates and organic solvents | | | | | | | | | | | | | | |
|---|---|-----------------|---|------|-----|-----|----------|-----|---------|-----|---------|-------|--------|-------|-------|
| Appearance | homogeneous mixture, workable, black in colour, all aggregate grains coated with binder | | | | | | | | | | | | | | |
| Grain size | G _f 85 | | | | | | | | | | | | | | |
| Grain size tolerance | deviation not greater than G _{TC} NR | | | | | | | | | | | | | | |
| Dust content | category not higher than f ₁₀ | | | | | | | | | | | | | | |
| Dust quality | category not higher than MB _f 10 | | | | | | | | | | | | | | |
| Aggregate angularity | category not lower than E _{CS} Declared | | | | | | | | | | | | | | |
| Grain density | 2800 ± 5% kg/m ³ | | | | | | | | | | | | | | |
| Workability at a temperature of 5°C | workable mixture | | | | | | | | | | | | | | |
| Grain size diameter from crushed aggregate | 0 to 8 mm | | | | | | | | | | | | | | |
| Grain size, content of grains passing through the sieve: | | | | | | | | | | | | | | | |
| <table border="1"> <thead> <tr> <th>Grain size [mm]</th> <th>Content of grains passing through the sieve [%]</th> </tr> </thead> <tbody> <tr> <td>11,2</td> <td>100</td> </tr> <tr> <td>8,0</td> <td>85 - 100</td> </tr> <tr> <td>5,6</td> <td>40 - 75</td> </tr> <tr> <td>2,0</td> <td>15 - 25</td> </tr> <tr> <td>0,125</td> <td>2 - 12</td> </tr> <tr> <td>0,063</td> <td>0 - 6</td> </tr> </tbody> </table> | | Grain size [mm] | Content of grains passing through the sieve [%] | 11,2 | 100 | 8,0 | 85 - 100 | 5,6 | 40 - 75 | 2,0 | 15 - 25 | 0,125 | 2 - 12 | 0,063 | 0 - 6 |
| Grain size [mm] | Content of grains passing through the sieve [%] | | | | | | | | | | | | | | |
| 11,2 | 100 | | | | | | | | | | | | | | |
| 8,0 | 85 - 100 | | | | | | | | | | | | | | |
| 5,6 | 40 - 75 | | | | | | | | | | | | | | |
| 2,0 | 15 - 25 | | | | | | | | | | | | | | |
| 0,125 | 2 - 12 | | | | | | | | | | | | | | |
| 0,063 | 0 - 6 | | | | | | | | | | | | | | |
| Soluble binder content remaining after evaporation of the volatile parts | 4,0 ÷ 6,0% (m/m) | | | | | | | | | | | | | | |
| Density | approx. 2,65 g/cm ³ | | | | | | | | | | | | | | |
| Free space content | < 25% (v/v) | | | | | | | | | | | | | | |
| Penetration with an inspection stamp | ≤ 2 mm | | | | | | | | | | | | | | |
| Adhesion of binder to aggregate | ≥ 80% | | | | | | | | | | | | | | |
| Application temperature | -10°C to +30°C | | | | | | | | | | | | | | |
| Consumption | approx. 2,2 t/m ³ approx. 2,2 kg/dm ³ | | | | | | | | | | | | | | |
| Reference document(s) | IBDiM-KOT-2020/0577 issue 1 from 2020 | | | | | | | | | | | | | | |

PROPERTIES

- Ready-to-use
- Can be used in a wide temperature range
- Compacted manually or mechanically
- For cold application
- Use of the pavement immediately after application



USED IN A WIDE TEMPERATURE RANGE

APPLICATION

- Partial repairs of asphalt and concrete pavements
- Filling in defects and potholes in pavements
- Filling in areas after installation work
- Filling in expansion joints, local levelling or profiling of road pavements, sidewalks and metal elements in the pavement structure (e.g. manholes, level crossings)
- Construction of ramps - creating smooth transitions between pavement and curb



HORIZONTAL



OUTDOOR USE

PACKAGING

Poland

- Bags: 25 kg
- Quantity per pallet:
- 1000 kg - 40 pcs.

Export

- Bags: 25 kg
- Quantity per pallet:
- 1000 kg - 40 pcs.

METHOD OF USE

▪ CONDITIONS OF USE

Works should not be carried out during precipitation and strong sunlight. Do not use the product inside rooms intended for human occupation and food industry use or for tarred materials. Use in an airy area, away from fire.

▪ SUBSTRATE PREPARATION

Trim the edges of a defect (hole) vertically and level the bottom. The defect should be in a shape of a simple geometric figure, e.g. a cuboid. The substrate under IZOHAN **RR**, should be thoroughly cleaned of loose pavement fragments, aggregate, debris and other contaminants. Do not apply the product to frozen/frosty surfaces. Dry the substrate to bring it to an air-dry state before applying the mineral-asphalt mix. Prime the bottom and sides of the defect with NEXLER Penetrator G7 or NEXLER BITFLEX Primer.

▪ PRODUCT CONTROL

Check the production date on the packaging before use. Bear in mind that, once the mix has been poured out of the bag, it is necessary to break down all the clumped pieces so as to obtain a homogeneous (loose) product structure.

The temperature of the mix must not be below 5°C in order to obtain the proper workability. During periods of reduced temperatures, store the product in a heated space for at least 24 hours before use.

▪ PRODUCT PREPARATION

IZOHAN **RR** is a mix ready to be cold-applied to the cavity. Breaking down of any clumped pieces can be done with a rake. Slight movement of loose aggregate fractions during mechanical breakup is characteristic of a properly prepared mix. This phenomenon, which can be referred to as particle shifting, is desirable and indicative of a correct structure of the material.

▪ APPLICATION METHOD

Thickness of a single applied layer should range between 2,5 and 4 cm. The maximum thickness of all layers jointly may not exceed 15 cm. If the pavement defect exceeds this depth, use a material similar in performance to the structure to be filled in at the bottom of the defect. When the product is being incorporated, the mix should extend above the surface level of the pavement by approximately 20% of the defect depth before compaction.

Depending on the size of the defects, IZOHAN **RR** should be compacted with a vibrating plate or hand tamp until a stable layer is obtained.

The incorporated final layer of the mineral-asphalt mix should be sprinkled with sand of 0 - 2 mm grain size or crushed gravel of 2 - 4 mm grain size in order to prevent the mix from sticking to car wheels. It is especially recommended to use a sprinkle in high temperatures. The edge between the incorporated mix and the pavement can be primed before applying the sprinkle to improve the bond between the materials and increase the durability of the repair.

Vehicular traffic is permitted immediately after the pavement repair.

▪ CONTROL OF PERFORMANCE

Once applied, the product should fill the substrate defect and not detach from the created pavement. The surface of the last compacted layer should extend 1 to 3 mm above the surface level of the pavement.

The repair done using IZOHAN **RR** mix is temporary with a durability of up to 6 months. The durability of the repair is mainly influenced by the quality of substrate preparation and the quality of compaction.

TOOLS AND TOOL CLEANING

Spade, rake, vibrating plate, hand tamper.

Clean tools with agents intended for removing asphalt and bituminous compounds.

STORAGE AND TRANSPORT

The shelf life of the product is 12 months from production date specified on the packaging. Store in dry and cool rooms, at temperature above +5°C, in tightly sealed, original packaging. Do not allow long exposure to high temperatures or sunlight during storage and transport.

The bagged mixture should be stored flat, in heaps or on pallets, stacked in a maximum of five layers. Prolonged storage of open packaging can cause the mixture to harden, making it unsuitable to be used again.

NOTES

Works should be carried out in accordance with technical conditions, manufacturer's instructions, health and safety standards and regulations.

For information on how to deal with symptoms of disease, allergies or irritation of the skin or eyes, please refer to the Safety Data Sheet (www.nexler.com).

After works are finished, hand over the remaining content of the product to authorised companies.

GENERAL RECOMMENDATIONS

Technical data and information on the method of use are given for a temperature of 23°C ± 2°C and a relative air humidity of 55%.

The consumption of the product given in this sheet depends on the preparation of the substrate.

IMPORTANT INFORMATION

Please refer to the detailed conditions of use of the product before use.

We guarantee the quality of our materials as part of our terms of sale and delivery. For buildings with special requirements that are not covered by this manual, we provide our Customers with our own professional advisory service.

The manufacturer has no influence on the improper use of the material, its use for other purposes or under conditions other than those described above. The guarantee only covers the quality of the delivered product. The correct and therefore effective use of the product is not subject to our control.

Neither the manufacturer nor his authorized representative may be held liable for any loss incurred as a result of improper use or storage of the product.

Employees of the company are authorized to provide technical information only and solely in accordance with this Technical Data Sheet. Information other than that contained in this sheet should be confirmed in writing.

If you have any doubts, consult the manufacturer.

CONTACT DETAILS

NEXLER sp. z o.o.

Łużycka 6, 81-537 Gdynia, Poland

tel.: +48 58 712 94 44

www.nexler.com

e-mail: dt@nexler.com

ISSUE DATE

This Technical Data Sheet was issued on 27.03.2025.

Once we have issued a new Technical Data Sheet, this one is no longer valid.

DETAILS

Detail of pavement at curb

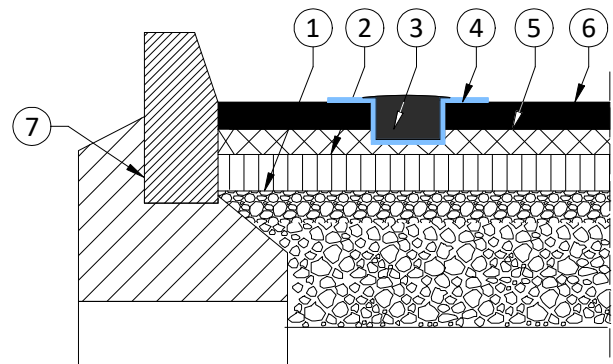

1. Subbase of aggregate not bound hydraulically
2. Roadbase
3. IZOHAN RR
4. Bituminous primer NEXLER BITFLEX Primer
5. Binder course
6. Wearing course
7. Concrete curb